

M21 Switch fuses base mounting 3P - 3P+N

Size 1

A 160|200|250



NH 0 BS A4
BS B1 BS B2



	CODE-160A	CODE-160A	CODE-200A	CODE-250A
3P	M2101603PSD00	M2101603PSB10	M2102003PSB20	M2102503PSB20
3P + N	M2101603NSD00	M2101603NSB10	M2102003NSB20	M2102503NSB20
Fuses	NH 0	BS A4	BS B1-BS B2	BS B1-BS B2

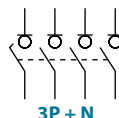
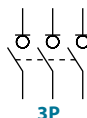

Technical information



According to IEC 60947-3

			160	200	250
Fuses	NH/DIN		0	-	05
	BS		A4	B1-B2	B1-B2
Rated thermal current in ambient at 40 °C	Ith	A	160	200	250
Rated thermal current in enclosure	Ithe	A	160	-	250
Rated insulation voltage	Ui	V	800	800	800
Rated impulse withstand voltage	Uimp	kV	8	8	8
Power dissipation in fuse links ^{*(1)}	NH/DIN	W	13,5	-	17,8
	BS		11	13	16
AC rated operational current ^{*(2)} (Rated frequency 50 / 60 Hz)	Ue 400 V AC21A	A	160	200	250
	Ue 400 V AC22A	A	160	200	250
	Ue 400 V AC23A	A	160	200	250

			160	200	250
Rated breaking capacity	400 V; cos φ = 0,35÷0,45	A	1280	1600	2000
Rated making capacity	400 V; cos φ = 0,45	A	1600	2000	2500
Short - circuit behaviour					
Rated conditional short-circuit current ^{*(3)}	Iq	kA rms	100	100	100
Rated conditional short-circuit making ^{*(3)}		kA rms	100	100	100
Maximum cut - off current		kA (peak)	26,3	26,3	26,3
Maximum power dissipation		A ² s (x 10 ³)	478	478	478
Number of mechanical operations (according to the standards, for other values please consult)		Cycles	8000	8000	8000
Maximum weight 3P		kg	3,1	3,1	3,1
Maximum weight 3P+N		kg	4	4	4

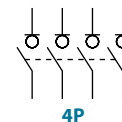

Also available 4P switches under request, please consult

^{*(1)} Power dissipation values of fuse - links used in type tests. Please consult for fuse - links with higher power dissipation
^{*(2)} Other voltages and / or utilization categories; please consult us
^{*(3)} With a protective device limiting the cut - off current and the joule integral to the indicated values

Accessories

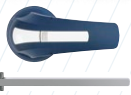

» External handle included shaft ^{*(e1)}
IP65
 CODE DS-SA11



» Emergency external handle included shaft ^{*(e1)}
IP65
 CODE DS-SR11



» Direct handle
 CODE DM2SI11

» Shafts

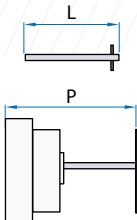

Standard shaft included ^{*(e1)}
 L (mm) | P (mm)
 227 | 180... 292

Shaft extensions
 Type 1
 L (mm) | P (mm) | CODE
 375 | 180... 441 | DS-EP14

» Rear protective plate

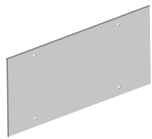

160-200 A | 250 A
 3P | 4P | 3P | 4P
 DM2PP11 | DM2PP12 | DM2PP21 | DM2PP22

Dimensions (mm)

Door drilling for external handle

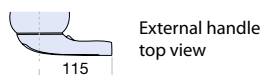
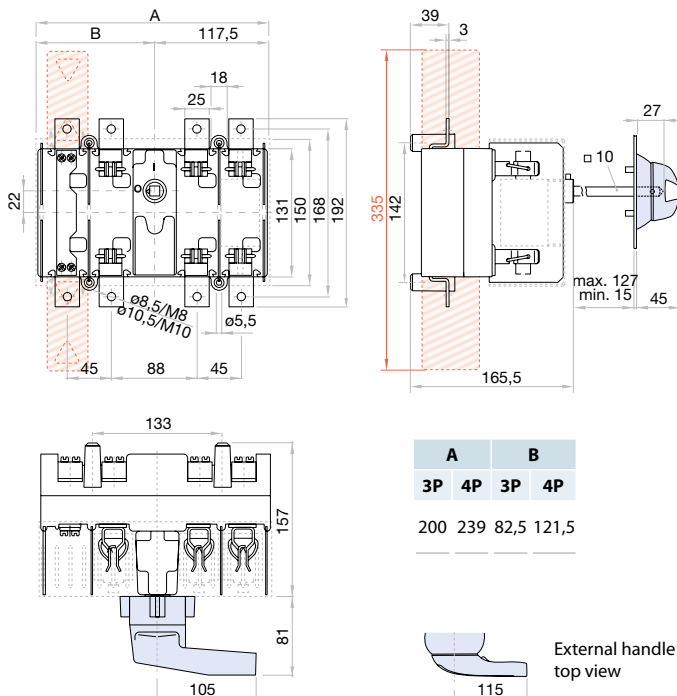
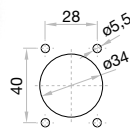

» Terminal shrouds



3P INPUT | 3P OUTPUT | 4P INPUT/OUTPUT
 DM2CU11 | DM2CU12 | DM2CU13
 (1 kit for input or output)

» Auxiliary contacts



1NO+1NC CODE D5LAU01
 2NO+2NC CODE D5LAU02
 Ie = 16 A (resistive loads)
 4 A (inductive loads) at 250 Vac.

» Safety key lock device



Simple CODE DS-CA11
 Double CODE DS-CEB1

For external handle, lock the handle by means of a key in position "OFF" (under request, in "ON"), the key can only be removed with the handle locked

Door drilling for handle and key lock device
 Simple | Double

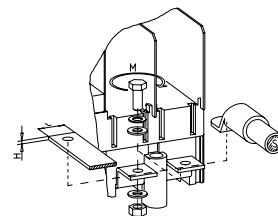
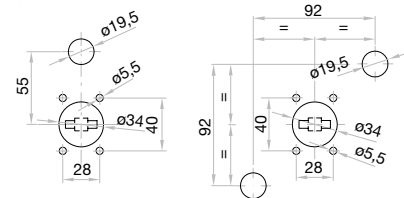

S max (Cu) mm ²	H max (Cu) mm	L max (Cu) mm	T	M	
160 A	120	5	25	M8	13
200 A	120	5	25	M10	24
250 A	120	5	25	M10	24

Fuses

Maximum dimensions

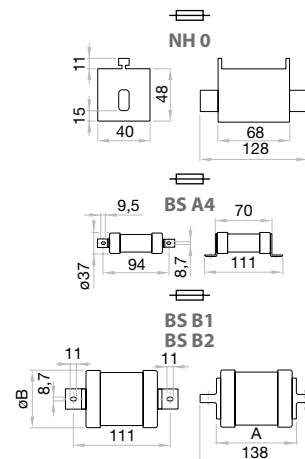

	A	øB
	max	max
B1	70	37
B2	77	42

M21 Switch fuses base mounting 3P - 3P+N

Size 2

A 250|315|400



NH 1 NH 2 BS B1
BS B2 BS B3 BS B4

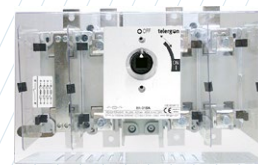

	CODE-250A	CODE-400A	CODE-315A	CODE-400A
3P	M2102503PSD10	M2104003PSD20	M2103153PSB40	M2104003PSB50
3P + N	M2102503NSD10	M2104003NSD20	M2103153NSB40	M2104003NSB50
Fuses	NH 1	NH 2	BS B1...BS B3	BS B1...BS B4

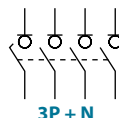
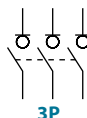

Technical information



According to IEC 60947-3

			250	315	400
Fuses	NH/DIN		1	-	2
	BS		-	B1-B3	B1-B4
Rated thermal current in ambient at 40 °C	Ith	A	250	315	400
Rated thermal current in enclosure	Ithe	A	250	-	400
Rated insulation voltage	Ui	V	1000	1000	1000
Rated impulse withstand voltage	Uimp	kV	12	12	12
Power dissipation in fuse links ^{*(1)}	NH/DIN	W	18,7	-	30
	BS		-	24	29
AC rated operational current ^{*(2)} (Rated frequency 50 / 60 Hz)	Ue 400 V AC21A	A	250	315	400
	Ue 400 V AC22A	A	250	315	400
	Ue 400 V AC23A	A	250	315	400

^{*(1)} Power dissipation values of fuse - links used in type tests. Please consult for fuse - links with higher power dissipation

^{*(2)} Other voltages and / or utilization categories; please consult us

^{*(3)} With a protective device limiting the cut - off current and the joule integral to the indicated values

			250	315	400
Rated breaking capacity	400 V; cos φ = 0,35÷0,45	A	2000	2520	3200
Rated making capacity	400 V; cos φ = 0,45	A	2500	3150	4000
Short - circuit behaviour					
Rated conditional short-circuit current ^{*(3)}	Iq	kA rms	100	100	100
Rated conditional short-circuit making ^{*(3)}		kA rms	100	100	100
Maximum cut - off current		kA (peak)	43,3	43,3	43,3
Maximum power dissipation		A ² s (x 10 ³)	1600	1600	1600
Number of mechanical operations (according to the standards, for other values please consult)		Cycles	8000	8000	5000
Maximum weight 3P		kg	6,6	6,6	6,6
Maximum weight 3P+N		kg	8	8	8

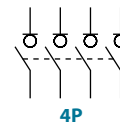

Also available 4P switches under request, please consult

Accessories



» External handle included shaft ^{*(e1)}

IP65
CODE DS-LA22



» Emergency external handle included shaft ^{*(e1)}

IP65
CODE DS-LR22



» Direct handle

CODE DM2SI21

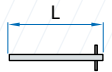

» Shafts

Standard shaft included ^{*(e1)}

L (mm)	P (mm)
239	216...286

Shaft extensions

Type 1

L (mm)	P (mm)	CODE
345	216...392	DS-EP23

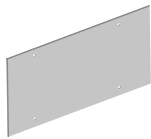

» Rear protective plate

3P	4P
DM2PP21	DM2PP22

Dimensions (mm)

Door drilling for external handle

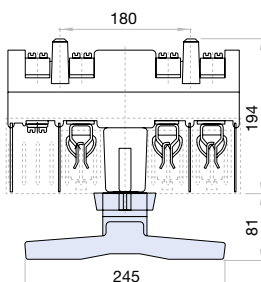
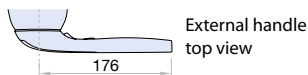
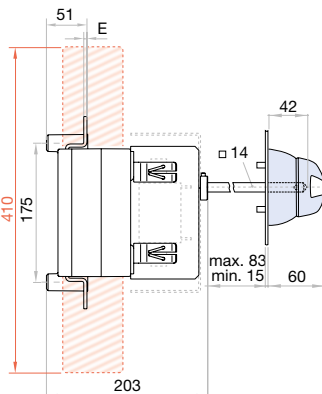
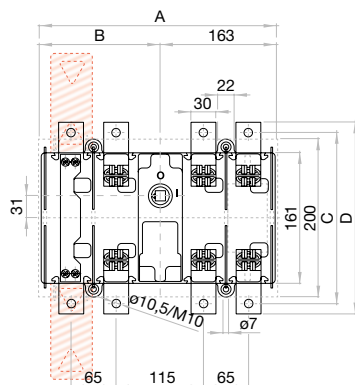
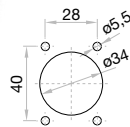

	A	B	C	D	E
	3P	4P	3P	4P	
250A			212	242	4
315A	274	329	111	166	
400A			216	246	5



» Terminal shrouds

3P INPUT DM2CU21	3P OUTPUT DM2CU22	4P INPUT/OUTPUT DM2CU23
---------------------	----------------------	----------------------------

(1 kit for input or output)



» Auxiliary contacts

1NO+1NC	CODE	D5LAU01
2NO+2NC	CODE	D5LAU02

Ie = 16 A (resistive loads)
4 A (inductive loads) at 250 Vac.



» Safety key lock device

Simple	CODE	DS-CB21
Double	CODE	DS-CF21

For external handle, lock the handle by means of a key in position "OFF" (under request, in "ON"), the key can only be removed with the handle locked

Door drilling for handle and key lock device

Simple

Double

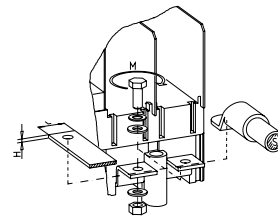
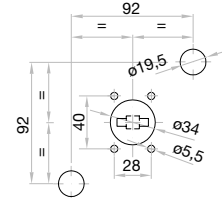
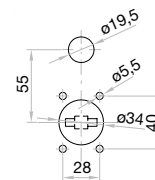

S max (Cu)	H max (Cu)	L max (Cu)	M
mm ²	mm	mm	Nxm
240	6	40	M10 24

Fuses

Maximum dimensions

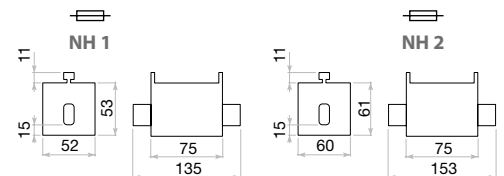

BS B1
BS B2
BS B3
BS B4

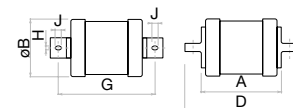

	A	øB	D	G	H	J
	max	max	max	nom	nom	min
B1	70	37				
B2	77	42	138	111	8,7	11
B3						
B4	83	66				

M21 Switch fuses base mounting 3P - 3P+N

Size 3

A 630|800



NH 3 BS C1 BS C2
BS C3

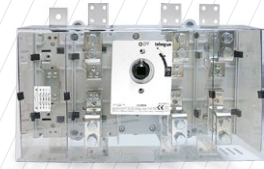
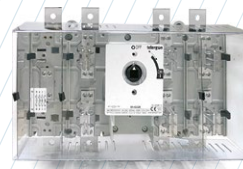
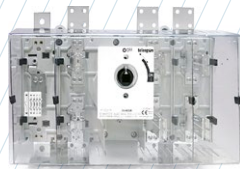
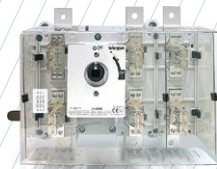

	CODE-630A	CODE-800A	CODE-630A	CODE-800A
3P	M2106303PSD30	M2108003PSD30	M2106303PSB70	M2108003PSB80
3P + N	M2106303NSD30	M2108003NSD30	M2106303NSB70	M2108003NSB80
Fuses	NH 3	NH 3	BS C1...BS C2	BS C1...BS C3

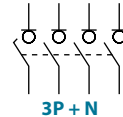
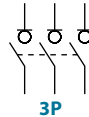

Technical information



According to IEC 60947-3

			630	800
Fuses	NH/DIN		3	3
	BS		C1-C2	C1-C3
Rated thermal current in ambient at 40 °C	Ith	A	630	800
Rated thermal current in enclosure	Ithe	A	630	725
Rated insulation voltage	Ui	V	1000	1000
Rated impulse withstand voltage	Uimp	kV	12	12
Power dissipation in fuse links ^{*(1)}	NH/DIN	W	48	57
	BS		44	63
AC rated operational current ^{*(2)} (Rated frequency 50 / 60 Hz)	Ue 400 V AC21A	A	630	800
	Ue 400 V AC22A	A	630	800
	Ue 400 V AC23B	A	630	630

			630	800
Rated breaking capacity	400 V; cos φ = 0,35÷0,45	A	5040	5040
Rated making capacity	400 V; cos φ = 0,45	A	6300	6300
Short - circuit behaviour				
Rated conditional short-circuit current ^{*(3)}	Iq	kA rms	100	100
Rated conditional short-circuit making ^{*(3)}		kA rms	100	100
Maximum cut - off current		kA (peak)	60,8	60,8
Maximum power dissipation		A ² s (x 10 ³)	4600	4600
Number of mechanical operations (according to the standards, for other values please consult)		Cycles	5000	3000
Maximum weight 3P		kg	13	13
Maximum weight 3P+N		kg	15	15

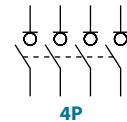

Also available 4P switches under request, please consult

^{*(1)} Power dissipation values of fuse - links used in type tests. Please consult for fuse - links with higher power dissipation
^{*(2)} Other voltages and / or utilization categories; please consult us
^{*(3)} With a protective device limiting the cut - off current and the joule integral to the indicated values

Accessories



» **External handle** included shaft ^{*(e1)}
 IP65
 CODE DS-LA31



» **Emergency external handle** included shaft ^{*(e1)}
 IP65
 CODE DS-LR31



» **Direct handle**
 CODE DM2SI31

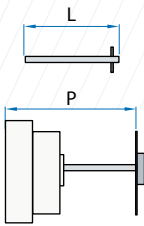

» **Shafts**
Standard shaft included ^{*(e1)}
 L (mm) | P (mm)
 186 | 235... 286

Shaft extensions
 Type 1
 L (mm) | P (mm) | CODE
 345 | 235... 445 | DS-EP23

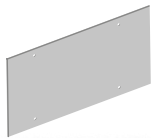

» **Rear protective plate**
 3P | 4P
 DM2PP31 | DM2PP32

Dimensions (mm)

Door drilling for external handle

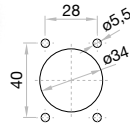

» **Terminal shrouds**

3P INPUT | 3P OUTPUT | 4P INPUT/OUTPUT
 DM2CU31 | DM2CU32 | DM2CU33
 (1 kit for input or output)



» **Auxiliary contacts**

1NO+1NC CODE D5LAU01
 2NO+2NC CODE D5LAU02

le = 16 A (resistive loads)
 4 A (inductive loads) at 250 Vac.



» **Safety key lock device**

Simple CODE DS-CB31
 Double CODE DS-CF31

For external handle, lock the handle by means of a key in position "OFF" (under request, in "ON"), the key can only be removed with the handle locked

Door drilling for handle and key lock device
 Simple | Double

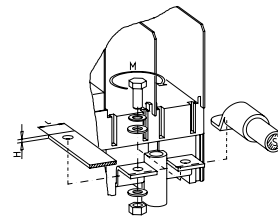
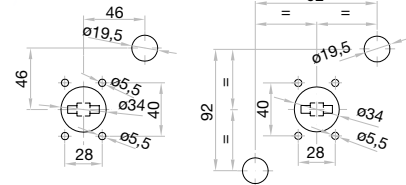

	S max (Cu) mm ²	H max (Cu) mm	L max (Cu) mm	M	M Nm
630 A	2x185	2x7	50	M12	45
800 A	2x240	2x7	50	M8	13

Fuses

Maximum dimensions

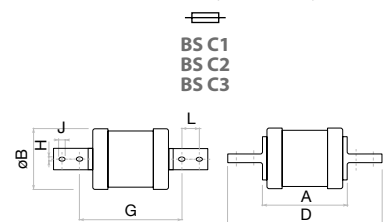
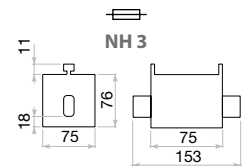

	A	B
3P	381	426
4P	166	211

	A	øB	D	G	H	J	L
C1	max 83	max 66				11	25,4
C2	85	77	212	133	10,3		
C3	89	84				12,5	

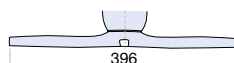
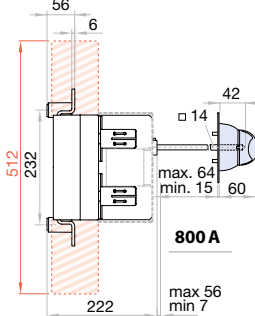
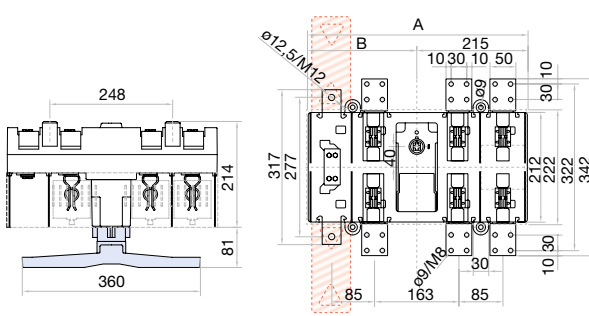
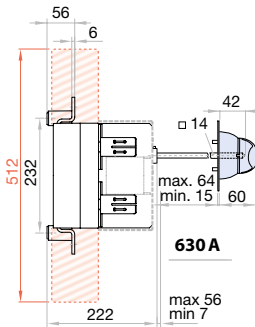
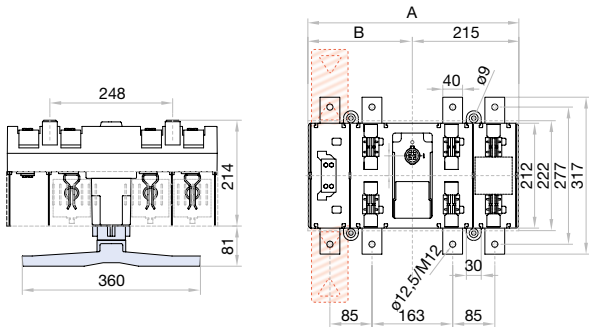

External handle top view