

Susol Molded Case Circuit Breaker TS630N

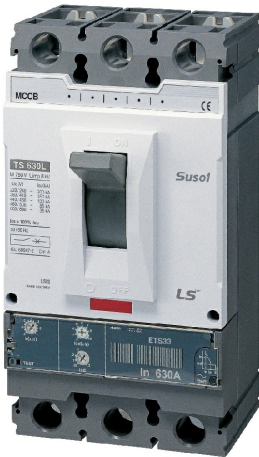

General

| | |
|-----------------------------|--------------------------|
| Product code | 0108006300 |
| Product description | TS630N ETS33 630A 3P EXP |
| Trip Unit | ETS(Electronic, LSI) |
| [In] rated current | 630 A at 40 °C |
| Poles description | 3P |
| Protected poles description | 3T |
| Neutral position | - |
| Network type | AC (50/60 Hz), DC |
| Upside connection | Front (screw) |
| Downside connection | Front (screw) |

Characteristics

| | |
|--|--------------|
| [Ue] rated operational voltage (AC 50/60 Hz) | 690 V AC |
| [Ue] rated operational voltage (DC) | 500 V DC |
| [Uimp] rated impulse withstand voltage | 8 kV |
| [Ui] rated insulation voltage | 1000 V |
| Mechanical durability | 20000 cycles |

| | |
|--|--|
| Electrical durability (AC) | 6000 cycles 415 V In |
| Electrical durability (DC) | - |
| Utilisation category | Category A |
| Suitability for isolation | Yes |
| Reference standard | IEC 60947-2 |
| [Icu] rated Ultimate short-circuit breaking capacity | 100 kA at 220/240 V AC 50/60 Hz, IEC 60947-2 |
| | 65 kA at 380/415 V AC 50/60 Hz, IEC 60947-2 |
| | 65 kA at 440/460 V AC 50/60 Hz, IEC 60947-2 |
| | 42 kA at 480/500 V AC 50/60 Hz, IEC 60947-2 |
| | 22 kA at 525 V AC 50/60 Hz, IEC 60947-2 |
| | 10 kA at 660/690 V AC 50/60 Hz, IEC 60947-2 |
| | 50 kA at 250 V DC, Reference |
| [Ics] rated service breaking capacity | 100 kA at 220/240 V AC 50/60 Hz, IEC 60947-2 |
| | 65 kA at 380/415 V AC 50/60 Hz, IEC 60947-2 |
| | 65 kA at 440/460 V AC 50/60 Hz, IEC 60947-2 |
| | 42 kA at 480/500 V AC 50/60 Hz, IEC 60947-2 |
| | 22 kA at 525 V AC 50/60 Hz, IEC 60947-2 |
| | 10 kA at 660/690 V AC 50/60 Hz, IEC 60947-2 |
| | 50 kA at 250 V DC, Reference |
| [Icm] rated short-circuit marking capacity | 220 kA at 220/240 V AC 50/60 Hz, IEC 60947-2 |
| | 143 kA at 380/415 V AC 50/60 Hz, IEC 60947-2 |
| | 143 kA at 440/460 V AC 50/60 Hz, IEC 60947-2 |
| | 88 kA at 480/500 V AC 50/60 Hz, IEC 60947-2 |
| | 46 kA at 525 V AC 50/60 Hz, IEC 60947-2 |
| | 17 kA at 660/690 V AC 50/60 Hz, IEC 60947-2 |
| [Icw] rated short-time | - |
| | - |

| | |
|---|--|
| withstand current | - |
| | - |
| Trip unit characteristics | Electronic |
| | L : for overload protection (long time) |
| | S : for short time short-circuit protection |
| | I : for instantaneous short-circuit protection |
| | - |
| | - |
| | - |
| | - |
| [Ir] Long-time pick-up adjustment range | Adjustable, 13 settings |
| | 0.4, 0.45, 0.5, 0.55, 0.6, 0.65, 0.7, 0.75, 0.8, 0.85, 0.9, 0.95, 1.0 x I _n |
| [Iu] Long-time pick-up adjustment range | - |
| | - |
| [tr] Long-time delay adjustment range | Fixed |
| | at 6 x I _r , tolerance ±20% |
| [Isd] Short-time pick-up adjustment range | Adjustable, 9 settings |
| | 1.5, 2, 3, 4, 5, 6, 7, 8, 10 x I _r , tolerance ±15% |
| [tsd] Short-time delay adjustment range | Adjustable, 4 settings |
| | - |
| | 50ms (Tripping time : 30ms < t ≤ 70ms) |
| | 100ms (Tripping time : 70ms < t ≤ 140ms) |
| | 200ms (Tripping time : 140ms < t ≤ 240ms) |
| | 300ms (Tripping time : 240ms < t ≤ 350ms) |
| - | |
| [Ii] Instantaneous pick-up adjustment range | Fixed |
| | 11 x I _n |

| | |
|--|---------------------------|
| | |
| [lg] Ground-fault protection pick-up adjustment range | - |
| | - |
| | - |
| [tg] Ground-fault protection time delay adjustment range | - |
| | - |
| | - |
| | - |
| Earth leakage pick-up adjustment range | - |
| | - |
| Earth leakage alarm time delay adjustment range | - |
| | - |
| Earth leakage trip time delay adjustment range | - |
| | - |
| [lp] Pre-trip alarm pick-up adjustment range | - |
| | - |
| [tp] Pre-trip alarm time delay adjustment range | - |
| | - |
| Alarm LED | Ir (90% ~ 105%) : Trun on |
| | Ir (105% ~) : Blink |

Environment

| | |
|---------------------------------------|-----------------|
| Pollution degree | 3, IEC 60664-1 |
| Degree of protection | IP20, IEC 60529 |
| Ambient air temperature for operation | -20...70 °C |
| Ambient air temperature for storage | -40...70 °C |
| Mounting mode | Fixed |

| | |
|-----------------------------------|--------------|
| Mounting support | Backplate |
| Approvals ¹⁾ (General) | CE (Europe) |
| | - |
| | - |
| | CCC (China) |
| | EAC (Russia) |
| | IC (Korea) |
| Approvals (shipping) | LR (U.K) |
| | BV (France) |
| | ABS (U.S.A) |
| | GL (Germany) |
| | DNV (Norway) |
| | RINA (Italy) |
| | KR (Korea) |

1) LS ELECTRIC's standard products are designed for CE.

To check the product with regional certificates, please contact LSE sales representatives.

Dimensions

| | | |
|---------|---------------------|--------|
| Product | Width | 140 mm |
| | Height | 260 mm |
| | Depth | 110 mm |
| | Weight | 5.4 kg |
| Packing | Width | 155 mm |
| | Height | 275 mm |
| | Depth | 174 mm |
| | Weight | 5.4 kg |
| | Quantity (in a box) | 1 pcs. |

TS400/630

[mm]

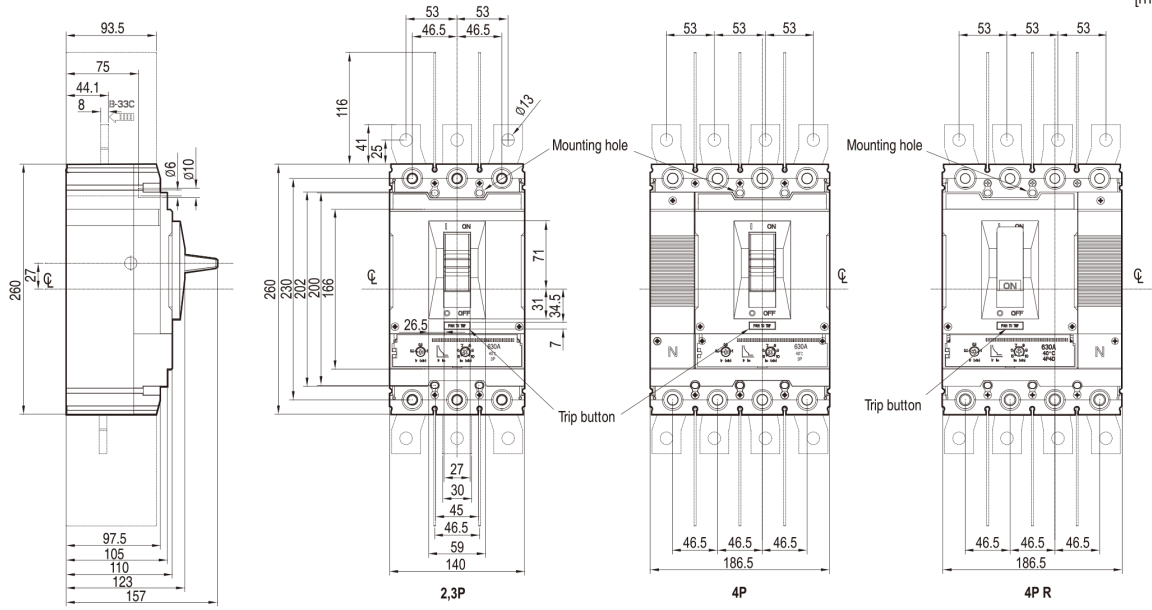

Terminal section

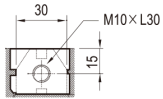

Conductor

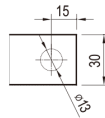

Panel drilling

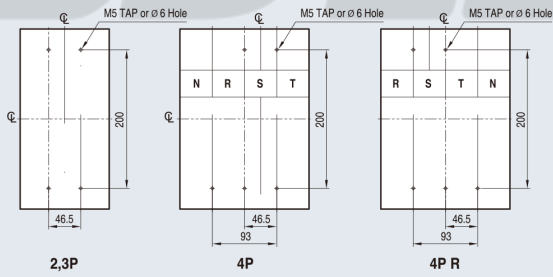

Front panel cutting

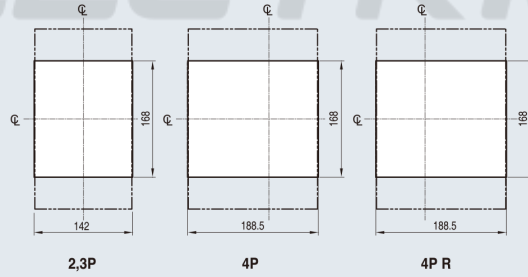

LS ***ELECTRIC***