

Miniature Circuit Breaker

BKN-b



General

| | |
|-------------------------------------|---|
| Product Code | 06110160R0 |
| Product Description | BKN-b 1P B1 NEW ROGY |
| [In] Rated current | 1A at 30? conforming to EN/IEC 60898-1 IEC60947-2 |
| [Ue] rated operational voltage | 240/415 V |
| Poles description | 1P |
| Number of protected poles | 1 |
| Network type | AC (50/60 Hz) |
| Type of trip | Thermal-magnetic |
| Neutral position | - |
| Earth-leakage sensitivity | - |
| Residual current off-time | - |
| Earth-leakage protection time delay | - |
| Earth-leakage protection class | - |

Characteristics

| | |
|--------------------------------|-------------------|
| Max. operating voltage Ub max. | 253 V AC |
| Min. operating voltage Ub min. | 24 V AC - 24 V DC |

| | |
|---|--|
| [Uimp] rated impulse withstand voltage | 4 kV |
| [Ui] rated insulation voltage | 500 V |
| Residual current tripping technology | - |
| Rated breaking and making capacity | - |
| Rated residual breaking and making capacity | - |
| [Inc] rated conditional short-circuit current | - |
| Contact position indicator | - |
| Mechanical durability | 10000 cycles |
| Electrical durability (AC) | 4000 cycles |
| Electrical durability (DC) | - |
| Utilisation category | - |
| Suitability for isolation | Yes |
| Reference standard | IEC 60898-1 |
| [Icu] rated Ultimate short-circuit breaking capacity | - |
| [Icn] rated short-circuit breaking capacity(IEC/EN 60898) | 10 kA at 240/415 V AC 50/60 Hz, IEC 60898-1 |
| [Ics] rated service breaking capacity | 7.5 kA at 240/415 V AC 50/60 Hz, IEC 60898-1 |
| [Icw] rated short-time withstand current | - |
| Thermomagnetic release characteristic(IEC/EN 60898) | B Curve |
| [Ii] Instantaneous pick-up adjustment range | - |

Environment

| | |
|------------------|---|
| Pollution degree | 3 |
|------------------|---|

| | |
|---------------------------------------|---|
| Degree of protection | IP20, IEC 60529 |
| Ambient air temperature for operation | -25...55 °C |
| Ambient air temperature for storage | -40...70 °C |
| Relative humidity | 95% at 55°C |
| Mounting | on DIN rail EN 60715(35mm) by means of fast clip device |
| Mounting mode | Fixed |
| Terminal type | Dual type(Lug&Screw type) |
| Terminal size top/bottom for cable | 25mm ² /25mm ² |
| Terminal size top/bottom for busbar | |
| Tightening torque | 2.0 N |
| Approvals ¹⁾ (General) | CE (Europe) |
| | - |
| | - |
| | EAC (Russia) |
| | - |
| | SNI (Indonesia) |
| | - |
| | RCM(Australia) |
| Approvals (Marine) | - |
| | - |
| | - |
| | - |
| | - |
| | - |
| | - |
| | - |

1) LS ELECTRIC's standard products are designed for CE.
To check the product with regional certificates, please contact LSE sales representatives.

Dimensions

| | | |
|---------------|---------------------|----------|
| Product | Width | 17.6 mm |
| | Depth | 68 mm |
| | Height | 81 mm |
| | Weight | 0.11 kg |
| Inner Packing | Width | 225 mm |
| | Depth | 80 mm |
| | Height | 88 mm |
| | Weight | 1.4 kg |
| | Quantity (in a box) | 12 pcs. |
| Outer Packing | Width | 470 mm |
| | Depth | 195 mm |
| | Height | 230 mm |
| | Weight | 15 kg |
| | Quantity (in a box) | 120 pcs. |

Combination with auxiliary elements

| | | |
|------------------|---|-----|
| Combination with | Auxiliary elements | Yes |
| Combination with | Signal contact/auxiliary switch contact | Yes |
| Combination with | Shunt trip | Yes |
| Combination with | UVT/OVT release | Yes |

Overall dimensions²⁾

BKN-b

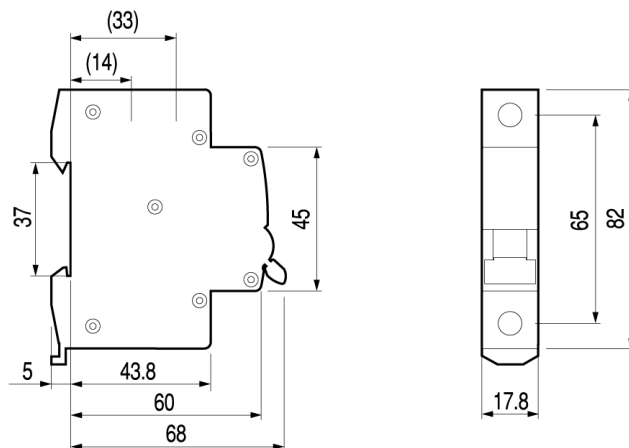

²⁾ Please multiple the number of poles when calculating the product width(W).