

Accessories



» External handle included shaft *(e1)
IP65
CODE DS-LA22



» Emergency external handle included shaft *(e1)
IP65
CODE DS-LR22



» Direct handle
CODE DM2SI21

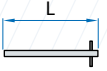

» Shafts

Standard shaft included *(e1)
L (mm) P (mm)
239 216...286

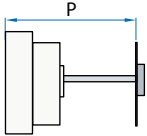

Shaft extensions
Type 1
L (mm) P (mm) CODE
345 216...392 DS-EP23

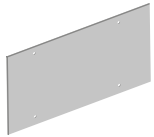

» Rear protective plate
3P DM2PP21 | 4P DM2PP22

Dimensions (mm)

Door drilling for external handle

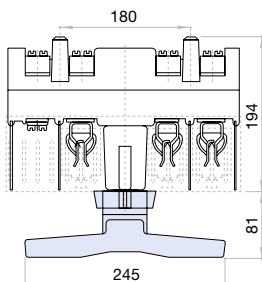
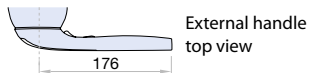
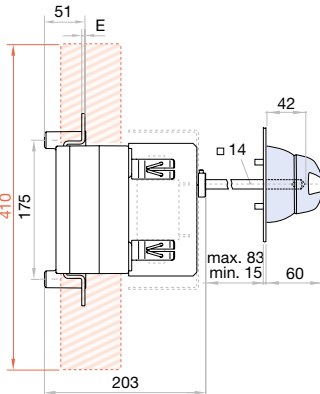
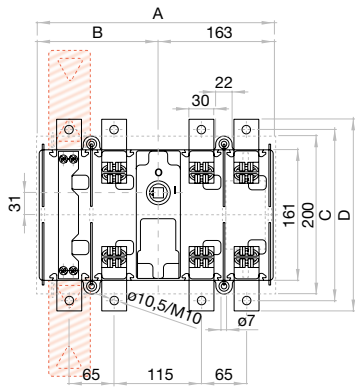
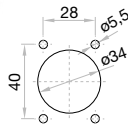

	A	B	C	D	E
	3P	4P	3P	4P	
250A			212	242	4
315A	274	329	111	166	
400A			216	246	5



» Terminal shrouds

3P INPUT DM2CU21 | 3P OUTPUT DM2CU22 | 4P INPUT/OUTPUT DM2CU23
(1 kit for input or output)



» Auxiliary contacts

1NO+1NC CODE D5LAU01
2NO+2NC CODE D5LAU02

Ie = 16 A (resistive loads)
4 A (inductive loads) at 250 Vac.



» Safety key lock device

Simple CODE DS-CB21
Double CODE DS-CF21

For external handle, lock the handle by means of a key in position "OFF" (under request, in "ON"), the key can only be removed with the handle locked

Door drilling for handle and key lock device
Simple Double

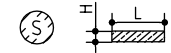
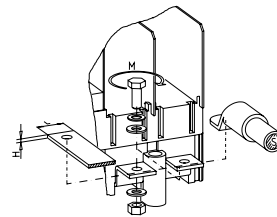
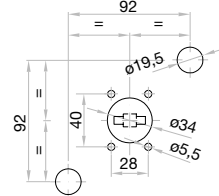
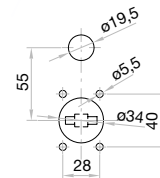

S max (Cu)	H max (Cu)	L max (Cu)	M
mm ²	mm	mm	Nxm
240	6	40	M10 24

Fuses

Maximum dimensions

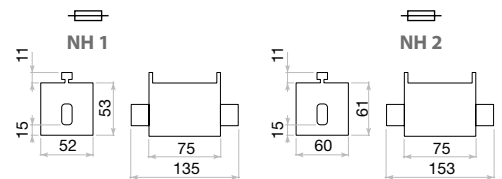

BS B1
BS B2
BS B3
BS B4

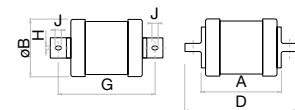

	A	øB	D	G	H	J
	max	max	max	nom	nom	min
B1	70	37				
B2	77	42	138	111	8,7	11
B3						
B4	83	66				