

Accessories

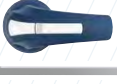

» Direct handle

CODE DS-LI21



» External handle included shaft ^{*(e1)}

IP65
CODE DS-LA21



» External handle without shaft

IP65
CODE DS-LA24



» Emergency external handle included shaft ^{*(e1)}

IP65
CODE DS-LR21



» Shafts

Standard shaft included ^{*(e1)}

L (mm)	P (mm)
195	134... 240

Shaft extensions

Type 1		
L (mm)	P (mm)	CODE
345	134... 400	DS-EP23

Type 2		
L (mm)	P (mm)	CODE
535	134... 560	DS-EP24



» Terminal protection

CODE DS-CU22
(1 unit for input or output)



» Terminal shrouds

CODE DS-CU21
(1 kit for input or output)



» Auxiliary contacts

1NO+1NC CODE D5LAU01
2NO+2NC CODE D5LAU02

I_e = 16 A (resistive loads)
4 A (inductive loads) at 250 Vac.



» Safety key lock device

Simple CODE DS-CB21
Double CODE DS-CF21

For external handle, lock the handle by means of a key in position "OFF" (under request, in "ON"), the key can only be removed with the handle locked

Door drilling for handle and key lock device

Simple

Double

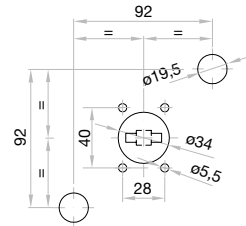
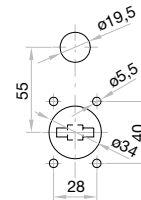

Dimensions (mm)

Door drilling for external handle

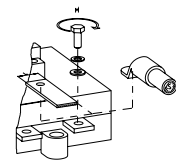
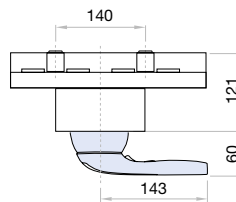
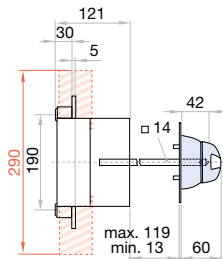
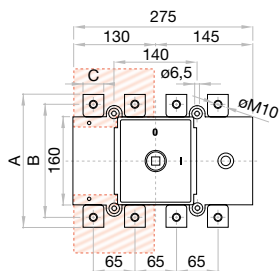
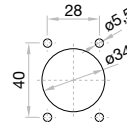

	A	B	C
500 A	220	190	25
630 A	235	205	30
800 A			

S max (Cu)	H max (Cu)	L max (Cu)	T	M
mm ²	mm	mm		Nxm
2x185	6	40	M10	24
2x240	2x5	40		
		50		

S5 AC Switch - disconnecter base mounting 3P - 3P+N

Size 3

A 800|1000|1250|2000



series
S5



CODE-800A

3P S5-08003PRO

3P + N S5-08003NR0



CODE-1000A

S5-10003PC0

S5-10003NC0



CODE-1250A

S5-12503PC0

S5-12503NC0



CODE-2000A

S5-20003PC0

S5-20003NC0



3P

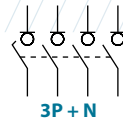

3P + N

Technical information

According to IEC 60947-3



consult



consult

tests:



		800 1000 1250 2000					
Rated thermal current in ambient at	lth	40 °C	A	800	1000	1250	2000
		50 °C	A	800	1000	1125	1800
		60 °C	A	800	900	900	1600
Rated insulation voltage	Ui	V		1000	1000	1000	1000
Rated impulse withstand voltage	Uimp	kV		12	12	12	12
AC rated operational current ^{*(1)} (Rated operational frequency 50/60 Hz)	Ie	Ue 400V AC21A	A	800	1000	1250	2000
		Ue 400V AC22A	A	800	1000	1250	2000 ^{*(3)}
		Ue 400V AC23A	A	800	1000	1000	-
Rated breaking capacity	400V AC23	A	6400	8000	8000	6000	
Rated making capacity	400V AC23	A	8000	10000	10000	6000	

^{*(1)} Other voltages and / or utilization categories. Please consult

^{*(2)} Without limiting protective device (short-circuit maintained 50... 100 ms.)

^{*(3)} AC22B

		800 1000 1250 2000				
Short - circuit behaviour						
Rated short-circuit making capacity ^{*(2)}	Icm	kA (peak)	60	60	60	80
Rated short-time withstand current (1sec.)	Icw	kA rms	25	25	25	38
Mechanical features						
Number of mechanical operations (according to the standards, for other values please consult)	Cycles		3000	3000	3000	3000
Maximum weight 3P	Kg		7	7	7	18,5
Maximum weight 3P+N	Kg		7,6	7,6	7,6	20

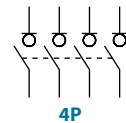

4P

Also available 4P switch - disconnectors under request, please consult

Connection diagram

Connection diagram
between front & rear

BI-1 S5-20003PC0
S5-20003NC0

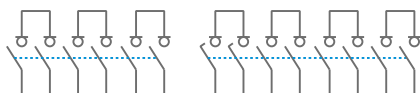

Bridging links ^{*(P2)}

