

# S5M AC Switch - disconnecter base mounting 6P - 8P

Size 1

A 250|315|400



series  
**S5M**

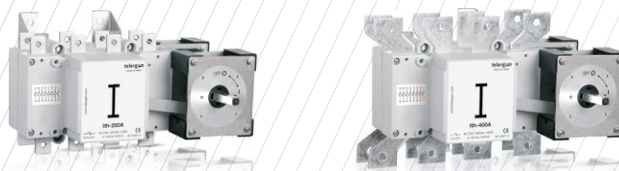

	CODE - 250A	CODE - 315A	CODE - 400A
6P	S5M02506PR0	S5M03156PR0	S5M04006PC0
8P	S5M02508PR0	S5M03158PR0	S5M04008PC0

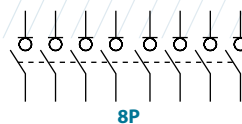

## Technical information



According to IEC 60947-3

			250	315	400	
Rated thermal current in ambient at	Ith	40 °C	A	250	315	400
		50 °C	A	250	315	400
		60 °C	A	250	315	320
Rated insulation voltage	Ui	V	1000	1000	1000	
Rated impulse withstand voltage	Uimp	kV	8	8	8	
AC rated operational current <sup>*(1)</sup> (Rated operational frequency 50/60 Hz)	Ie	Ue 400V AC21A	A	250	315	400
		Ue 400V AC22A	A	250	315	400
		Ue 400V AC23A	A	250	315	400
Rated breaking capacity	400V AC23	A	2000	2520	3200	
Rated making capacity	400V AC23	A	2500	3150	4000	

<sup>\*(1)</sup> Other voltages and / or utilization categories. Please consult

<sup>\*(2)</sup> Without limiting protective device (short-circuit maintained 50... 100 ms.)

			250	315	400
<b>Short - circuit behaviour</b>					
Rated short-circuit making capacity <sup>*(2)</sup>	Icm kA (peak)		20	20	20
Rated short-time withstand current (1sec.)	Icw kA rms		12	12	12
<b>Mechanical features</b>					
Number of mechanical operations (according to the standards, for other values please consult)	Cycles		8000	8000	5000
Maximum weight 6P	Kg		5,5	5,5	5,7
Maximum weight 8P	Kg		5,8	5,8	6

Accessories



» Direct handle

CODE DS-LI12



» Terminal protection <sup>\*(T)</sup>

CODE DS-CU12

(1 unit for input or output only frontal side)



» External handle included shaft <sup>\*(e1)</sup>

IP65

CODE DS-LA12



» Terminal shrouds <sup>\*(T)</sup>

CODE DS-CU11

(1 kit for input or output only frontal side)



» External handle without shaft

IP65

CODE DS-LA15



» Phase barrier <sup>\*(T)</sup>

	6P	8P
	DS-PB12	DS-PB11
	DS-PB14	DS-PB13

(1 kit for input or output)

<sup>\*(T)</sup> These accessories aren't compatible with each other.



» Emergency external handle included shaft <sup>\*(e1)</sup>

IP65

CODE DS-LR12



» Safety key lock devices

Simple CODE DS-CB12

Double CODE DS-CF11

For external handle, lock the handle by means of a key in position "OFF" (under request, in "ON"), the key can only be removed with the handle locked

» Shafts

Standard shaft included <sup>\*(e1)</sup>

L (mm)	P (mm)
277	288... 422

Door drilling for handle and key lock device

Simple

Double

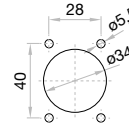
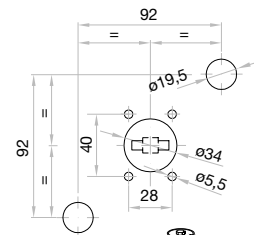
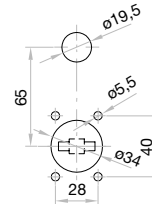

» Auxiliary contacts

1NO+1NC CODE DS-AU11  
2NO+2NC CODE DS-AU12

I<sub>e</sub> = 16 A (resistive loads)  
4 A (inductive loads) at 250 Vac.

Dimensions (mm)

Door drilling for external handle

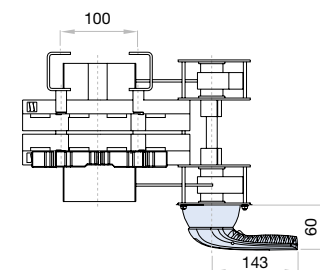
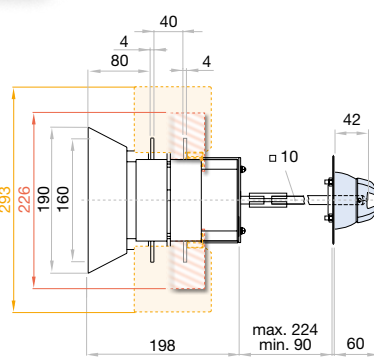
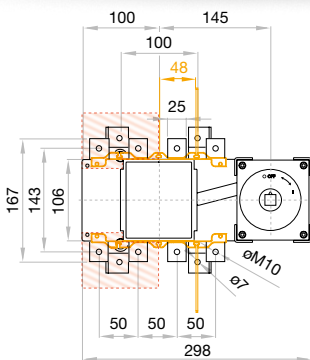

	S max (Cu)	H max (Cu)	L max (Cu)	T	M
250 A	185	7	25	M10	18

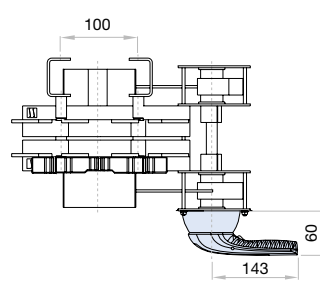
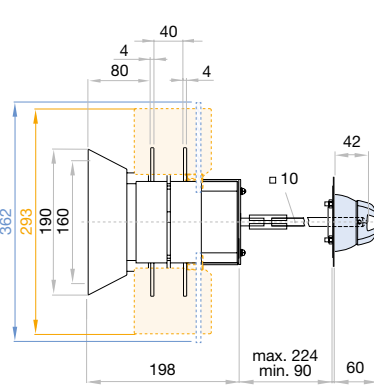
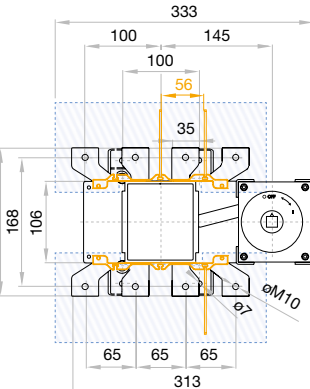

	S max (Cu)	H max (Cu)	L max (Cu)	T	M
400 A	240	7	40	M10	24