

series
S6 DC

S6 DC

Switch - disconnecter for DC current 1P - 2P

Size 1

A 125|160|200|250|315|400



500 - 750 - 1000Vdc

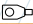

CODE-500 Vdc 

125A	S6-0125 __ S0
160A	S6-0160 __ S0
200A	S6-0200 __ S0
250A	S6-0250 __ S0
315A	S6-0315 __ S0
400A	S6-0400 __ D0

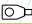
CODE-750 Vdc 

125A	S6-0125 __ S0
160A	S6-0160 __ S0
200A	S6-0200 __ S0
250A	S6-0250 __ S0
315A	S6-0315 __ S0
400A	S6-0400 __ D0

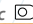
CODE-1000 Vdc 

125A	S6-0125 __ S0
160A	S6-0160 __ S0
200A	S6-0200 __ S0
250A	S6-0250 __ S0
315A	S6-0315 __ S0
400A	S6-0400 __ D0

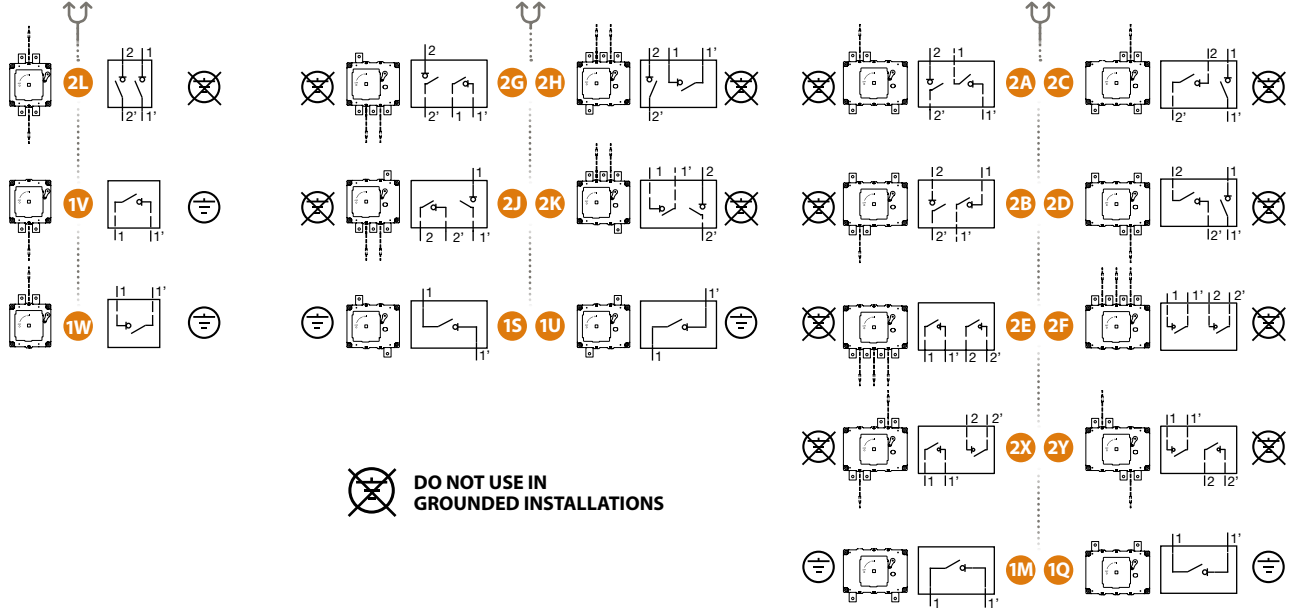

 **DO NOT USE IN GROUNDED INSTALLATIONS**

Technical information



According to IEC 60947-1
IEC 60947-3

			125	160	200	250	315	400	
Rated thermal current in ambient at	I _{th}	40° C	A	125	160	200	250	315	400
		50° C	A	125	160	200	250	315	400
		60° C	A	125	160	200	250	315	400
Rated insulation voltage (DC)	U _i	V	1500	1500	1500	1500	1500	1500	
Rated impulse withstand voltage	U _{imp}	kV	12	12	12	12	12	12	
Rated operational current ^{*(1)}	I _e	Code 500Vdc	A	125	160	200	250	315	400
		Code 750Vdc	A	125	160	200	250	315	400
		Code 1000Vdc	A	125	160	200	250	315	400

			125	160	200	250	315	400
Short - circuit behaviour								
Rated short-circuit making capacity ^{*(2)}	I _{cm}	kA (peak)	10	10	10	10	10	10
Rated short-time withstand current (1sec)	I _{cw}	kA rms	10	10	10	10	10	10
Mechanical features								
Number of mechanical operations (according to the standards, for other values please consult)	Cycles		8000	8000	8000	8000	8000	5000
Maximum weight	Consult according to code							

^{*(1)} Other voltages and / or utilization categories. Please consult
^{*(2)} Without limiting protective device (short-circuit maintained 50... 100 ms.)



Accessories

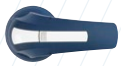

» Direct handle

CODE DS-SI11



» External handle included shaft^{*(e1)}

IP65
CODE DS-SA11



» External handle without shaft

IP65
CODE DS-SA14



» Terminal shrouds

CODE DR-CU11 (1 unit)
CODE DR-CU12 (1 unit)
CODE DR-CU13 (1 unit)



» Phase barriers

CODE DR-SF11 (1 unit)
CODE DR-SF12 (2 units)
CODE DR-SF13 (3 units)



» Spacers

CODE DR-EL11 (4 units)

» Shafts

Standard shaft included^{*(e1)}

L (mm)	P (mm)
227	103... 256

Shaft extensions

Type 1		
L (mm)	P (mm)	CODE
375	103... 415	DS-EP14

Type 2		
L (mm)	P (mm)	CODE
536	103... 576	DS-EP15

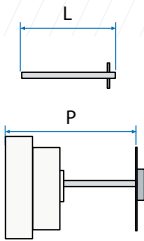

» Auxiliary contacts

1NO+1NC CODE D5LAU01
2NO+2NC CODE D5LAU02

Ie = 16 A (resistive loads)
4 A (inductive loads) at 250 Vac.



» Safety key lock device

Simple CODE DS-CA11
Double CODE DS-CE11

For external handle, lock the handle by means of a key in position "OFF" (under request, in "ON"), the key can only be removed with the handle locked

Door drilling for handle and key lock device
Simple Double

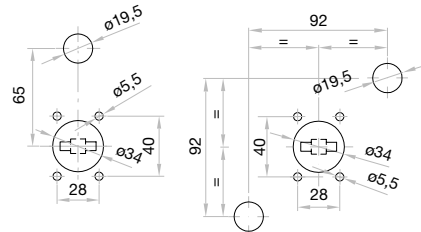

Dimensions (mm)

Door drilling for external handle

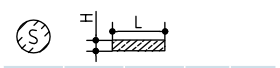
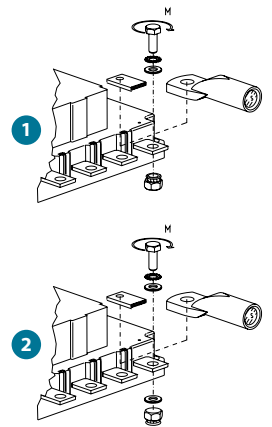
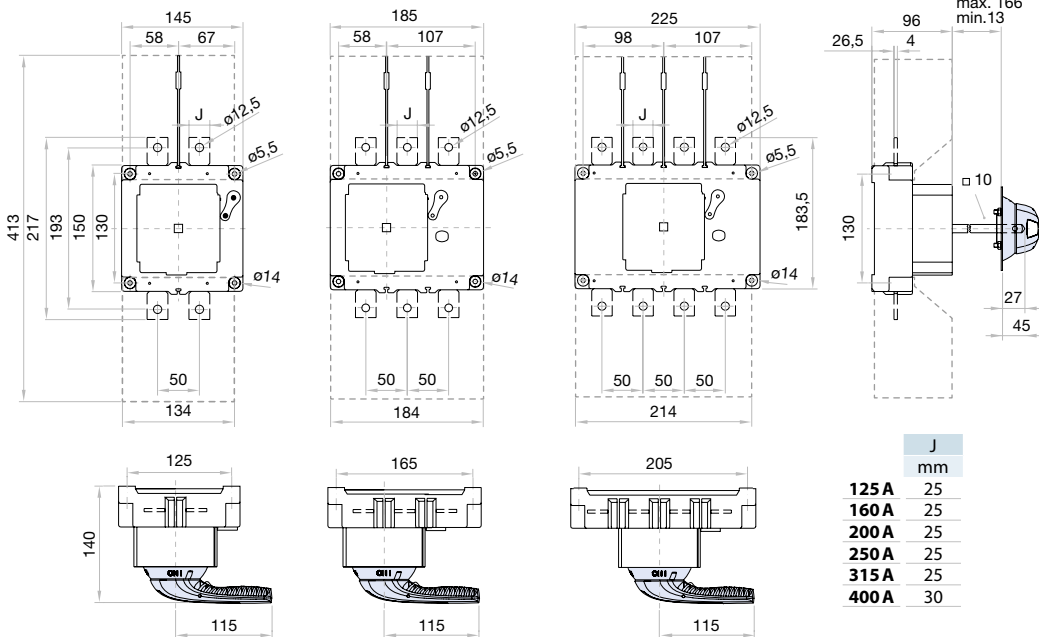
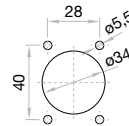

	S max (Cu) mm ²	H max (Cu) mm	L max (Cu) mm	T	M
125 A	185	8	25	M10	18
160 A	185	8	25	M10	18
200 A	185	8	25	M10	18
250 A	185	8	25	M10	18
315 A	185	8	25	M10	18
400 A	240 ^{*(t1)}	8	30	M10	18

^{*(t1)} Using phase barriers DR-SF... to maintain the required clearance.