

series  
**S5 DC**



# S5 DC Switch - disconnecter for DC current 4P

Size 2

A 500|630



1000Vdc



CODE-500A

S5-06304PRO

CODE-630A

S5-06302ERO

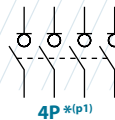

## Technical information

According to IEC 60947-1  
IEC 60947-3



tests:

			500	630
Rated thermal current in ambient at	Ith	40° C	A 500	630
		50° C	A 500	630
		60° C	A 400	500
Rated insulation voltage DC20	Ui	V	1500	1500
Rated impulse withstand voltage	Uimp	kV	12	12
Rated operational current *(1) DC21B	Ie	Ue		
		1000 Vdc	A 500	630

\*(1) Other voltages and / or utilization categories. Please consult

\*(2) Without limiting protective device (short-circuit maintained 50... 100 ms.)

			500	630
<b>Short - circuit behaviour</b>				
Short - circuit making capacity *(2)	Icm	kA (peak)	26	26
Rated short-time withstand current (1sec.)	Icw	kA rms	16	16
Number of mechanical operations (according to the standards, for other values please consult)	Cycles		5000	5000
Maximum weight (without bridging links)	Kg		4,5	4,5



**DO NOT USE IN GROUNDED INSTALLATIONS**

## Connection diagram

### Connection diagram

A



### Bridging links \*(p1)

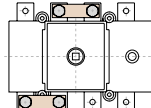

### Terminal shrouds

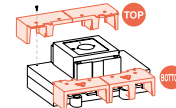

B

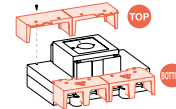
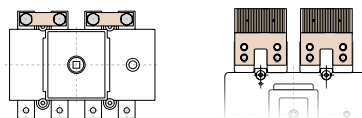

C

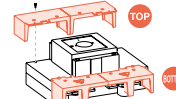
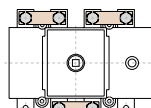



Accessories



» Direct handle

CODE DS-LI21



» External handle included shaft<sup>\*(e1)</sup>

IP65  
CODE DS-LA21



» External handle without shaft

IP65  
CODE DS-LA24

» Shafts

Standard shaft included<sup>\*(e1)</sup>

L (mm)	P (mm)
195	134... 240

Shaft extensions

Type 1		
L (mm)	P (mm)	CODE
345	134... 400	DS-EP23

Type 2		
L (mm)	P (mm)	CODE
535	134... 560	DS-EP24



» Auxiliary contacts

1NO+1NC CODE D5LAU01  
2NO+2NC CODE D5LAU02

Ie = 16 A (resistive loads)  
4 A (inductive loads) at 250 Vac.



» Terminal protection

CODE DS-CU22  
(1 unit for input or output)



» Terminal shrouds (2 units - only for 500A)

	A	B	C
TOP	DS-CU28	DS-CU20	DS-CU20
BOTTOM	DS-CU29	DS-CU21	DS-CU28



» Bridging links<sup>\*(p1)</sup>

A	B	500A CODE DS-PI21 (2 units)
C		CODE CONSULT
B		630A CODE DS-PI2D (2 units)

<sup>\*(p1)</sup> To comply with the operation and electrical features, the bridging links must be assembled to the switch. Please consult.

Dimensions (mm)

Door drilling for external handle

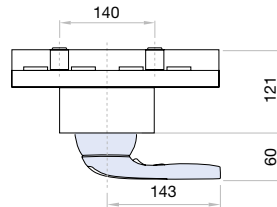
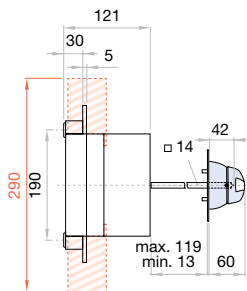
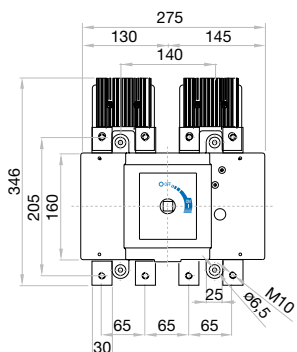
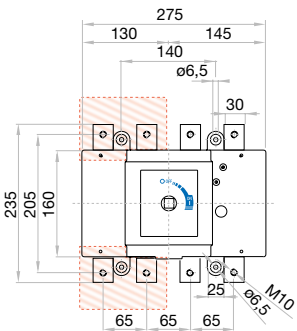
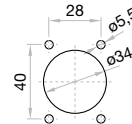

500 A

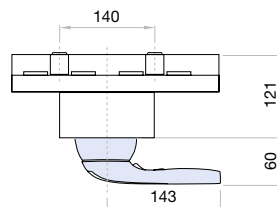
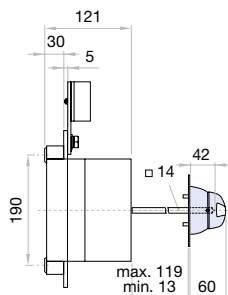
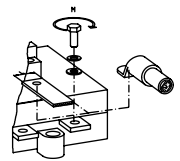

630 A

	S max (Cu) mm <sup>2</sup>	H max (Cu) mm	L max (Cu) mm	T	M Nxm
500A	2x240	2x5	40	M10	24
630A			50		

