

# M21 Switch fuses base mounting 3P - 3P+N

Size 3

A 630|800



NH 3 BS C1 BS C2  
BS C3

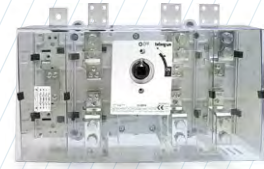
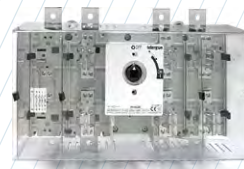
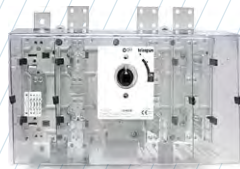
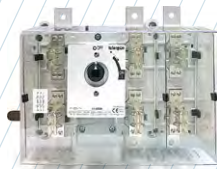

	CODE-630A	CODE-800A	CODE-630A	CODE-800A
<b>3P</b>	M2106303PSD30	M2108003PSD30	M2106303PSB70	M2108003PSB80
<b>3P + N</b>	M2106303NSD30	M2108003NSD30	M2106303NSB70	M2108003NSB80
<b>Fuses</b>	NH 3	NH 3	BS C1...BS C2	BS C1...BS C3

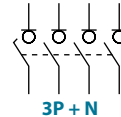
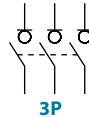

## Technical information



According to IEC 60947-3

			630	800
Fuses	NH/DIN		3	3
	BS		C1-C2	C1-C3
Rated thermal current in ambient at 40 °C	I <sub>th</sub>	A	630	800
Rated thermal current in enclosure	I <sub>the</sub>	A	630	725
Rated insulation voltage	U <sub>i</sub>	V	1000	1000
Rated impulse withstand voltage	U <sub>imp</sub>	kV	12	12
Power dissipation in fuse links <sup>*(1)</sup>	NH/DIN	W	48	57
	BS		44	63
AC rated operational current <sup>*(2)</sup> (Rated frequency 50 / 60 Hz)	U <sub>e</sub> 400 V AC21A	A	630	800
	U <sub>e</sub> 400 V AC22A	A	630	800
	U <sub>e</sub> 400 V AC23B	A	630	630

			630	800
Rated breaking capacity	400 V; cos φ = 0,35÷0,45	A	5040	5040
Rated making capacity	400 V; cos φ = 0,45	A	6300	6300
<b>Short - circuit behaviour</b>				
Rated conditional short-circuit current <sup>*(3)</sup>	I <sub>q</sub>	kA rms	100	100
Rated conditional short-circuit making <sup>*(3)</sup>		kA rms	100	100
Maximum cut - off current		kA (peak)	60,8	60,8
Maximum power dissipation		A <sup>2</sup> s (x 10 <sup>3</sup> )	4600	4600
Number of mechanical operations (according to the standards, for other values please consult)		Cycles	5000	3000
Maximum weight 3P		kg	13	13
Maximum weight 3P+N		kg	15	15

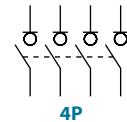

Also available 4P switches under request, please consult

<sup>\*(1)</sup> Power dissipation values of fuse - links used in type tests. Please consult for fuse - links with higher power dissipation  
<sup>\*(2)</sup> Other voltages and / or utilization categories; please consult us  
<sup>\*(3)</sup> With a protective device limiting the cut - off current and the joule integral to the indicated values

Accessories



» **External handle** included shaft <sup>\*(e1)</sup>  
 IP65  
 CODE DS-LA31



» **Emergency external handle** included shaft <sup>\*(e1)</sup>  
 IP65  
 CODE DS-LR31



» **Direct handle**  
 CODE DM2SI31

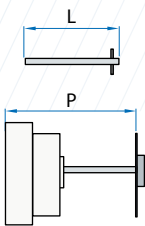

» **Shafts**  
**Standard shaft** included <sup>\*(e1)</sup>  
 L (mm) | P (mm)  
 186 | 235... 286

**Shaft extensions**  
 Type 1  
 L (mm) | P (mm) | CODE  
 345 | 235... 445 | DS-EP23

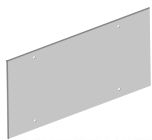

» **Rear protective plate**  
 3P | 4P  
 DM2PP31 | DM2PP32

Dimensions (mm)

Door drilling for external handle

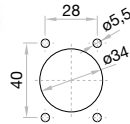

» **Terminal shrouds**

3P INPUT | 3P OUTPUT | 4P INPUT/OUTPUT  
 DM2CU31 | DM2CU32 | DM2CU33  
 (1 kit for input or output)



» **Auxiliary contacts**

1NO+1NC CODE D5LAU01  
 2NO+2NC CODE D5LAU02

Ie = 16 A (resistive loads)  
 4 A (inductive loads) at 250 Vac.



» **Safety key lock device**

Simple CODE DS-CB31  
 Double CODE DS-CF31

For external handle, lock the handle by means of a key in position "OFF" (under request, in "ON"), the key can only be removed with the handle locked

Door drilling for handle and key lock device  
 Simple | Double

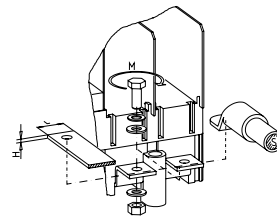
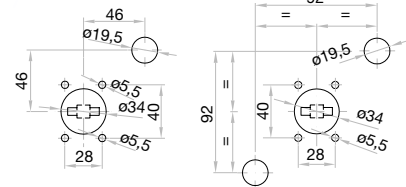

	S max (Cu) mm <sup>2</sup>	H max (Cu) mm	L max (Cu) mm	M	M Nm
630 A	2x185	2x7	50	M12	45
800 A	2x240	2x7	50	M8	13

Fuses

Maximum dimensions

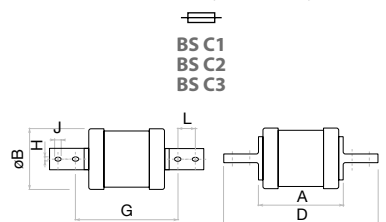
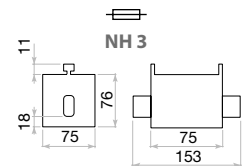

	A	B
3P	381	166
4P	426	211

	A	øB	D	G	H	J	L
	max	max	max	nom	nom	min	min
C1	83	66				11	25,4
C2	85	77	212	133	10,3		
C3	89	84				12,5	

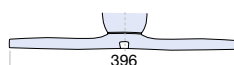
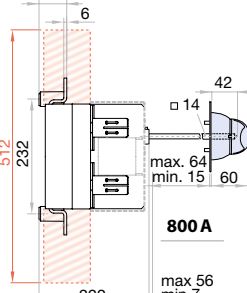
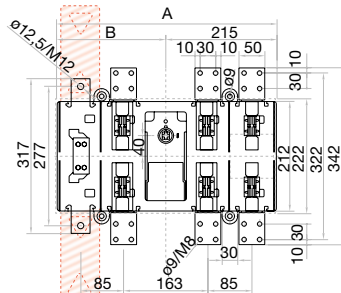
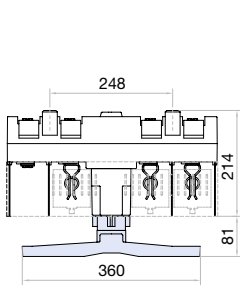
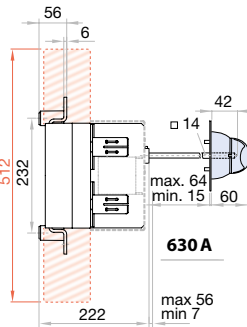
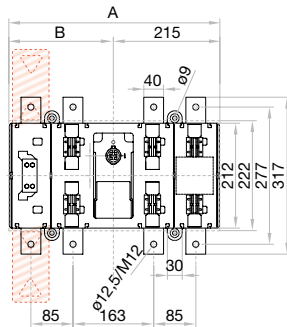
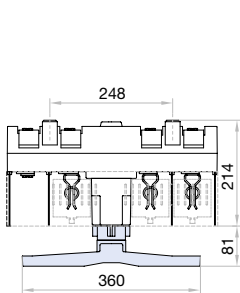

External handle top view