

CCF | CCP

Changeover switch base mounting 3P - 3P+N

Size 1

A 200|250|315|400



series
CCF|CCP

CCF

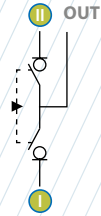

CCP

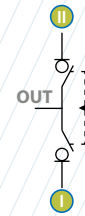

CODE-200A

CODE-250A

CODE-315A

CODE-400A

CCF	3P	CCF02003PS0	CCF02503PS0	CCF03153PS0	CCF04003PS0
	3P + N	CCF02003NS0	CCF02503NS0	CCF03153NS0	CCF04003NS0
CCP	3P	CCP02003PS0	CCP02503PS0	CCP03153PS0	CCP04003PS0
	3P + N	CCP02003NS0	CCP02503NS0	CCP03153NS0	CCP04003NS0

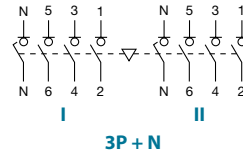
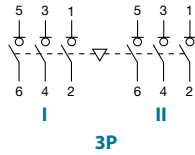

Technical information



According to IEC 60947-3

			200	250	315	400
Rated thermal current	I _{th} in ambient at 40° C	A	200	250	315	400
Rated insulation voltage	U _i	V	1000	1000	1000	1000
Rated impulse withstand voltage	U _{imp}	kV	8	8	8	8
AC Rated operational current ^{*(1)}	I _e U _e 400V AC21A	A	200	250	315	400
(Rated operational frequency 50/60 Hz)	U _e 400V AC22A	A	200	250	315	400 ^{*(3)}

^{*(1)} Other voltages and/or utilization categories; please consult
^{*(2)} Without limiting protective device (short - circuit maintained 50 ms. - 100 ms.)
^{*(3)} AC22B

			200	250	315	400
Rated breaking capacity	400V AC22	A	600	750	945	1200
Rated making capacity	400V AC22	A	600	750	945	1200
Short - circuit behaviour						
Short - circuit making capacity ^{*(2)}	I _{cm}	kA (peak)	12	12	12	12
Short - time withstand current (1 sec.)	I _{cw}	kA rms	8	8	8	8
Number of mechanical operations (according to the standards, for other values please consult) ^{*(3)}	Cycles		8000	8000	8000	5000
Maximum weight (3/4 poles)	CCF	Kg	4,8/5,3	4,8/5,3	5/5,5	5/5,5
	CCP	Kg	5,3/5,9	5,3/5,9	5,5/6	5,5/6

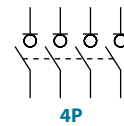
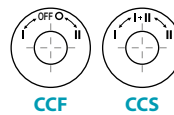

There are versions of changeover switches without OFF 0 position: "overlapped contacts":
CCF (I - I+II - II) = CCS please consult

Also available 4P changeover switches under request, please consult



Accessories



» Direct handle

CODE DCCL11



» External handle included shaft^{*(e1)}

IP65
CODE DCCLA11

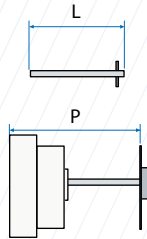

» Shafts

Standard shaft included ^{*(e1)}

L (mm)	P (mm)
227	166... 293

Shaft extensions

Type 1		CODE
L (mm)	P (mm)	
375	166... 442	DS-EP14

Type 2		CODE
L (mm)	P (mm)	
536	166... 602	DS-EP15

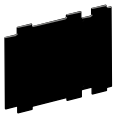

» Rear protective plate

3P	4P
DCCPP11	DCCPP12



» Terminal shrouds

Inputs		Common output	
POS. I 3P	POS. II 3P	POS. I&II 3P+N	3P
DM2CU12	DM2CU11	DM2CU13	DCCCU11
			DCCCU12



» Auxiliary contacts

1NO+1NC	CODE	D5LAU01
2NO+2NC	CODE	D5LAU02

I_e = 16 A (resistive loads)
4 A (inductive loads) at 250 Vac.



» Safety key lock device

Simple	CODE	D5LCB11
Double	CODE	D5LCF11

For external handle, lock the handle by means of a key in position "OFF" (under request, in "ON"), the key can only be removed with the handle locked

Door drilling for handle and key lock device

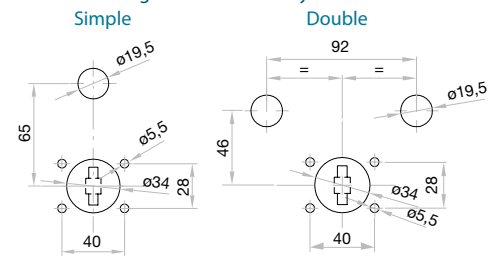

Dimensions (mm)

Door drilling for external handle

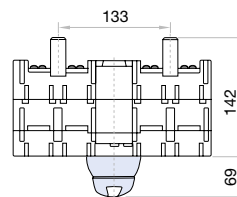
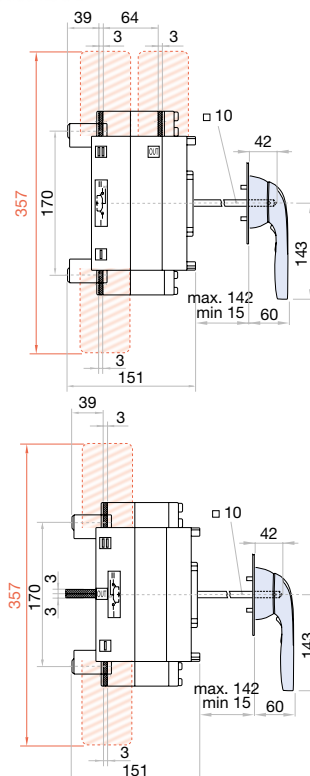
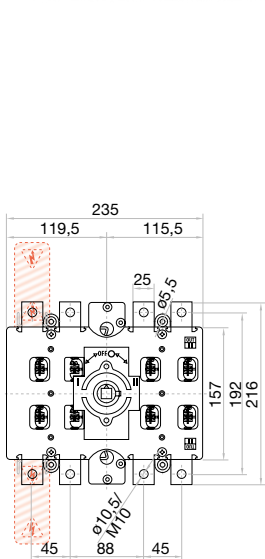
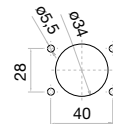

CCF

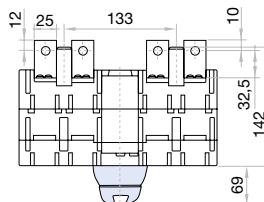

CCP

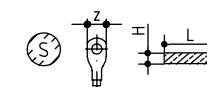
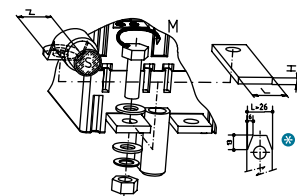

S max (Cu)	Z max	H max (Cu)	L max (Cu)	M
mm ²		mm	mm	Nxm
240	31	2x5	30	M10 24