

CCF | CCP Changeover switch base mounting 3P - 3P+N

Size 3

A 1000|1250



series
CCF|CCP

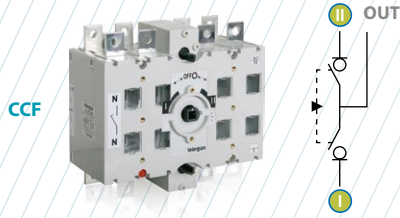

		CODE - 1000A	CODE - 1200A
CCF	3P	CCF10003PS0	CCF12503PS0
	3P + N	CCF10003NS0	CCF12503NS0
CCP	3P	CCP10003PS0	CCP12503PS0
	3P + N	CCP10003NS0	CCP12503NS0

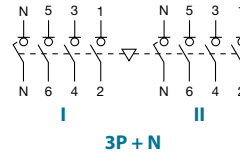
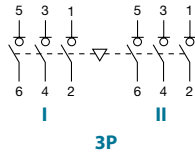

Technical information



According to IEC 60947-3

				1000	1250
Rated thermal current	I _{th} in ambient at 40° C	A		1000	1250
Rated insulation voltage	U _i	V		1000	1000
Rated impulse withstand voltage	U _{imp}	kV		12	12
AC Rated operational current ^{*(1)} (Rated operational frequency 50/60 Hz)	I _e U _e 400V AC21A	A		1000	1250
	U _e 400V AC22B	A		1000	1250

				1000	1250
Rated breaking capacity	400V AC22	A		3000	3750
Rated making capacity	400V AC22	A		3000	3750
Short - circuit behaviour					
Short - circuit making capacity ^{*(2)}	I _{cm}	kA (peak)		32	32
Short - time withstand current (1 sec.)	I _{cw}	kA rms		25	25
Number of mechanical operations (according to the standards, for other values please consult)		Cycles		3000	3000
Maximum weight (3/4 poles)	CCF	Kg		22,5 / 25	24,3 / 27,3
	CCP	Kg		25 / 28,3	26 / 29,7

^{*(1)} Other voltages and/or utilization categories; please consult

^{*(2)} Without limiting protective device (short - circuit maintained 50 ms. - 100 ms.)

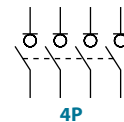
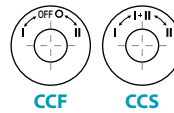

There are versions of changeover switches without OFF 0 position: "overlapped contacts":
CCF (I - I+II - II) = CCS _____, please consult

Also available 4P changeover switches under request, please consult



Accessories



» Direct handle

CODE DCCLI31



» External handle included shaft ^{*(e1)}

IP65
CODE DCCLA31

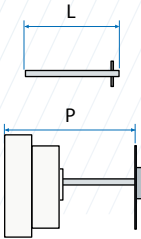

» Shafts

Standard shaft included ^{*(e1)}

L (mm)	P (mm)
186	223... 298

Shaft extensions

Type 1		
L (mm)	P (mm)	CODE
345	223... 457	DS-EP23

Type 2		
L (mm)	P (mm)	CODE
535	223... 645	DS-EP24

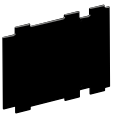

» Rear protective plate

3P	4P
DCCPP31	DCCPP32



» Terminal shrouds

POS. I	Inputs	POS. II	POS. I&II	Common output
3P	3P	3P+N	3P+N	3P 3P+N
DM2CU32	DM2CU31	DM2CU33	DCCCU31	DCCCU32



» Auxiliary contacts

1NO+1NC	CODE	D5LAU01
2NO+2NC	CODE	D5LAU02

I_e = 16 A (resistive loads)
4 A (inductive loads) at 250 Vac.



» Safety key lock device

Simple	CODE	D5LCB31
Double	CODE	D5LCF31

For external handle, lock the handle by means of a key in position "OFF" (under request, in "ON"), the key can only be removed with the handle locked

Door drilling for handle and key lock device

Simple

Double

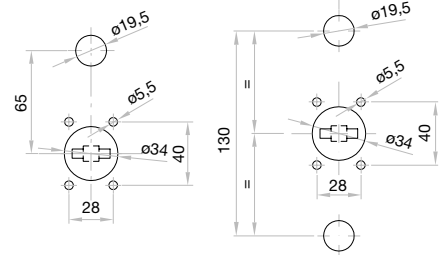

Dimensions (mm)

Door drilling for external handle

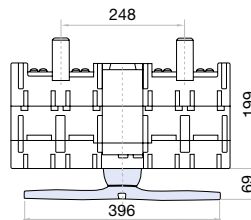
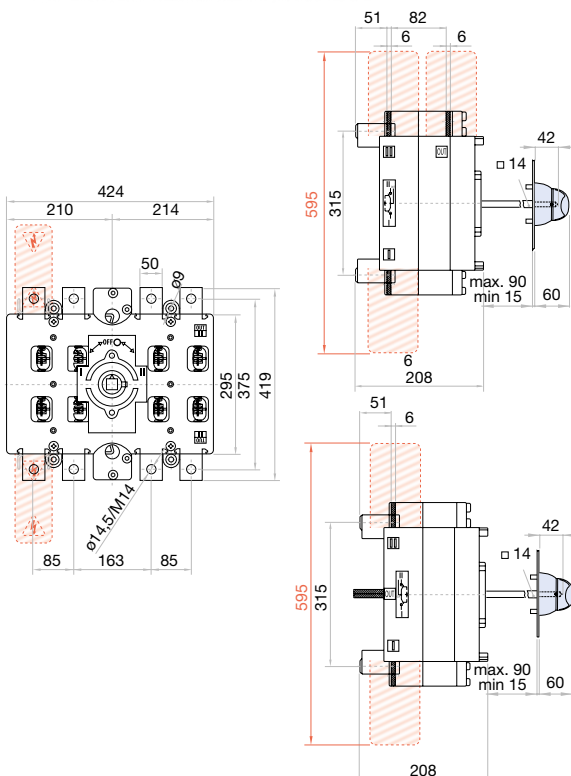
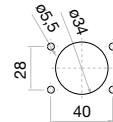

CCF

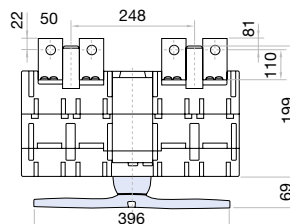

CCP

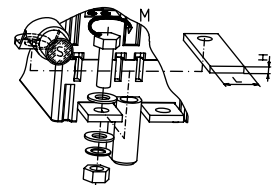

H max (Cu)	L max (Cu)	M
mm	mm	Nxm
2x10	60	M14 55